

RESIDENTIAL PROPERTY RECORD CARD

Date Printed 06/26/19

Owner Information

Parcel **1501020350000000**
 Owner **GREGG, BRYAN D**

2719 SCENIC HILLS DR
 LEWISTON, ID 83501

Location **0R3 2719 SCENIC HILLS DR**
 Descr: **SCENIC HILLS~LT 35 BK 2~~**

Parcel Value Information

Land Value	60,000	Homestead	0
Dwelling Value	347,800	Housesite	0
Site Imprvmt	0		
Outbuildings	28,900		
Misc. Adj.	0		
Total	436,700		

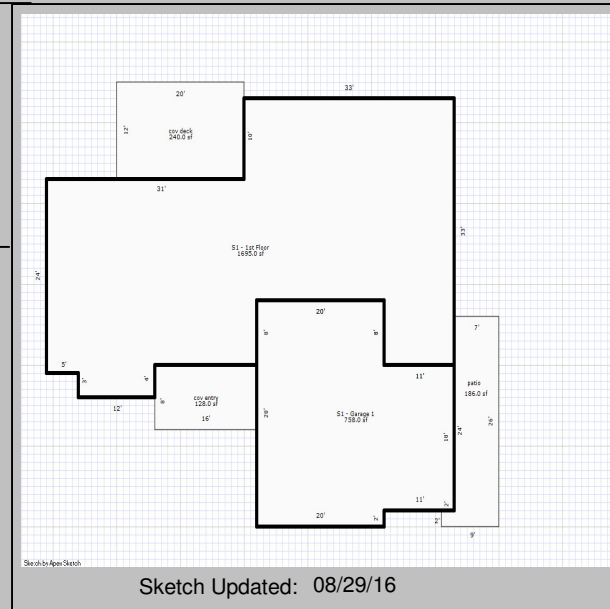

Parcel Information

Tax Map #	/35/2	NBHD	20
Span		Acres	2.56
Status	A - Active	Last Update	06/26/19

Sales Information

Book	361913	Sale Date	05/31/19
Page	52221	Sale Price	529,000

BUILDING	Total Rooms	0	Year Built	2016	Building SF	1695	Energy Adj	No Data	Roughins	1
	Bedrooms	0	Effect Age	1.0	Quality	4.00	Bsmt Wall	Conc 8"	Plumb Fixt	17
	Full Baths	0	Condition	Average	Style	1 Story	Bsmt SF	1652.00	Fireplaces	0
	Half Baths	0	Phys Depr	0	Design	No Data	Bsmt Fin	Partition	Porch	554
	Kitchens	0	Funct Depr	0	Bldg Type	Single	Bsmt Fin SF	1652	Gar/Shed	758
			Econ Depr	0					% Complete:	0

INSPECT	INSP.	NoData	INSP.	NoData	INSP.	NoData	APPT	NoData	APPTSCHD
----------------	-------	--------	-------	--------	-------	--------	------	--------	----------

NOTES