

PROPERTY DATA REVIEW CARD

Date Printed 01/19/21

Owner Information

Parcel 11030000100000000
 Owner GRAVES, KYLE & KRISTEN
 LANGLEY, MICHAELA & JORDAN
 PO BOX 1904
 LEWISTON, ID 83501

Location 0R1 2244 REEVES CT

Descr: PLEASANT HILLS 2ND ADDN~LOT 1~~YB
 1970 SQ 960 FB

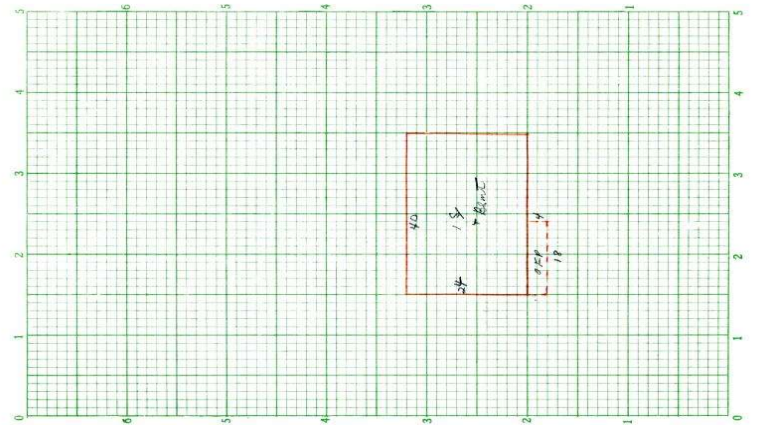

Parcel Information

Tax Map # /1/ NBHD 8
 Span Acres 0.17
 Status A - Active Last Update 01/19/21

Sales Information

Book 369219 Sale Date 12/04/20
 Page 53741 Sale Price 253,125

BUILDING	Total Rooms	0	Gar/Shed	0	Year Built	1970
	Bedrooms	2	Building SF	960	Effect Age	60.0
	Full Baths	2	Quality	1.00	Condition	Poor
	Half Baths	0	Bsmt SF	960.00	Phys Depr	58
	Kitchens	1	Bsmt Fin	Partition		
	Fireplaces	0	Bsmt Fin SF	600		