

RESIDENTIAL PROPERTY RECORD CARD

Date Printed 11/07/17

Owner Information

Parcel 10010202400010000
 Owner NASH, MARIANNE
 220 CHESTNUT ST
 CLARKSTON, WA 99403
 Location 0R1 220 CHESTNUT ST
 Descr: CLARKSTON~E66' OF LTS 23 & 24 BK
 2~~26X56 NASHUA 1995

Parcel Value Information

Land Value 30,000 Homestead 0
 Dwelling Value 59,400 Housesite 0
 Site Imprvmt 1,400
 Outbuildings 9,000
 Misc. Adj. 0
 Total 99,800

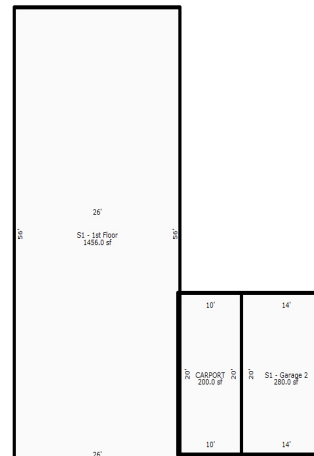

Parcel Information

Tax Map # //2 NBHD 12
 Span Acres 0.15
 Status I - Inactive Last Update 11/28/16

Sales Information

Book 50579 Sale Date 09/19/17
 Page 50579 Sale Price 154,000

Sketch by Apex Search

Sketch Updated: 12/03/12

BUILDING	Total Rooms	0	Year Built	1995	Building SF	1456	Energy Adj	No Data	Roughins	1
	Bedrooms	3	Effect Age	17.0	Quality	3.50	Bsmt Wall	NoData	Plumb Fixt	9
	Full Baths	2	Condition	Average	Style	1 Story	Bsmt SF	0.00	Fireplaces	0
	Half Baths	0	Phys Depr	36	Design	DbiWide	Bsmt Fin	No Data	Porch	0
	Kitchens	1	Funct Depr	0	Bldg Type	Mobile	Bsmt Fin SF	0	Gar/Shed	200
			Econ Depr	0					% Complete:	0

INSPECT INSP. NoData INSP. NoData INSP. NoData APPT NoData APPTSCHD

NOTES