

## RESIDENTIAL PROPERTY RECORD CARD

Date Printed 03/15/19

### Owner Information

Parcel 10030400400040000  
 Owner MOEN, DAVID B  
 KRANTZ, STEFANIE L  
 1226 10TH ST  
 CLARKSTON, WA 99403  
 Location OR2 1226 10TH ST  
 Descr: SOUTH CLARKSTON~N72' E1/2 LOT 4 BLK  
 4~~YB 1911 SQ 1036 NO B

### Parcel Value Information

Land Value	30,000	Homestead	0
Dwelling Value	79,000	Housesite	0
Site Imprvmt	0		
Outbuildings	15,700		
Misc. Adj.	0		
<b>Total</b>	<b>124,700</b>		

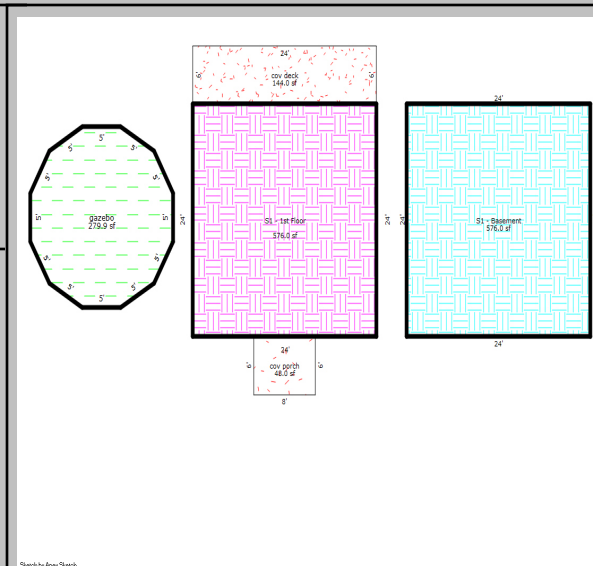

### Parcel Information

Tax Map #	/4/4	NBHD	12
Span		Acres	0.23
Status	I - Inactive	Last Update	01/31/19

### Sales Information

Book	360209	Sale Date	12/14/18
Page	51816	Sale Price	160,000

Sketch Updated: 11/20/12

<b>BUILDING</b>	Total Rooms	0	Year Built	1911	Building SF	1036	Energy Adj	No Data	Roughins	1
	Bedrooms	3	Effect Age	102.0	Quality	2.00	Bsmt Wall	NoData	Plumb Fixt	7
	Full Baths	1	Condition	Average	Style	1 Story	Bsmt SF	0.00	Fireplaces	0
	Half Baths	0	Phys Depr	15	Design	No Data	Bsmt Fin	No Data	Porch	160
	Kitchens	1	Funct Depr	0	Bldg Type	Single	Bsmt Fin SF	0	Gar/Shed	0
			Econ Depr	0					% Complete:	0

<b>INSPECT</b>	INSP.	NoData	INSP.	NoData	INSP.	NoData	APPT	NoData	APPTSCHD
----------------	-------	--------	-------	--------	-------	--------	------	--------	----------

**NOTES**  
 SALE IN CLUDE PARCEL 10030400400030000