

RESIDENTIAL PROPERTY RECORD CARD

Date Printed 10/31/19

Owner Information

Parcel 10010100700020000  
 Owner ADAMS, ASHLEY M

922 RIVERVIEW BLVD  
 CLARKSTON, WA 99403

Location OR1 922 RIVERVIEW BLVD

Descr: CLARKSTON~CLARKSTON BLK 1 LT 7~~YB  
 1948 SQ 1032 FB

Parcel Value Information

Land Value 52,500 Homestead 0  
 Dwelling Value 121,900 Housesite 0  
 Site Imprvmt 0  
 Outbuildings 26,900  
 Misc. Adj. 0  
 Total 201,300

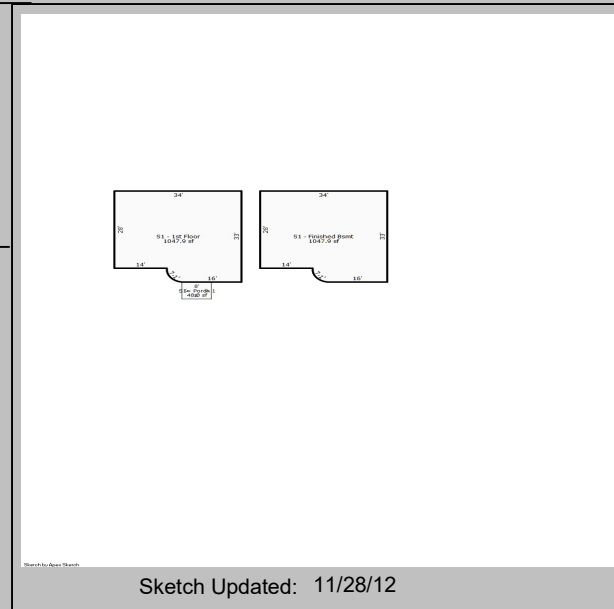

Sketch Updated: 11/28/12

Parcel Information

Tax Map # 7/1 NBHD 12  
 Span Acres 0.21  
 Status A - Active Last Update 10/31/19

Sales Information

Book 363732 Sale Date 10/30/19  
 Page 52685 Sale Price 204,500



BUILDING	Total Rooms	7	Year Built	1948	Building SF	1032	Energy Adj	No Data	Roughins	1
	Bedrooms	2	Effect Age	35.0	Quality	2.50	Bsmt Wall	Conc 8"	Plumb Fixt	8
	Full Baths	2	Condition	Average	Style	1 Story	Bsmt SF	1032.00	Fireplaces	1
	Half Baths	0	Phys Depr	24	Design	No Data	Bsmt Fin	Partition	Porch	688
	Kitchens	1	Funct Depr	0	Bldg Type	Single	Bsmt Fin SF	1032	Gar/Shed	0
			Econ Depr	0					% Complete:	0

INSPECT INSP. NoData INSP. NoData INSP. NoData APPT NoData APPTSCHD

NOTES CURRENTLY LISTED FOR \$220,000 7-10-19