

RESIDENTIAL PROPERTY RECORD CARD

Date Printed 05/21/19

Owner Information

Parcel 1619000780000000
 Owner BECKMAN-NIGRO, KELLY
 CRAVENS, STEPHEN E
 2205 PITCHSTONE DR
 CLARKSTON, WA 99403
 Location 0R1 2205 PITCHSTONE DR
 Descr: THE RIDGES AT DRY GULCH~LT 78~~YB
 2007 SQ 2574 2S

Parcel Value Information

Land Value 52,600 Homestead 0
 Dwelling Value 295,800 Housesite 0
 Site Imprmnt 0
 Outbuildings 29,700
 Misc. Adj. 0
 Total 378,100

Parcel Information

Tax Map # /78/ NBHD 9
 Span Acres 0.69
 Status A - Active Last Update 05/06/19

Sales Information

Book 361270 Sale Date 04/03/19
 Page 52079 Sale Price 167,500

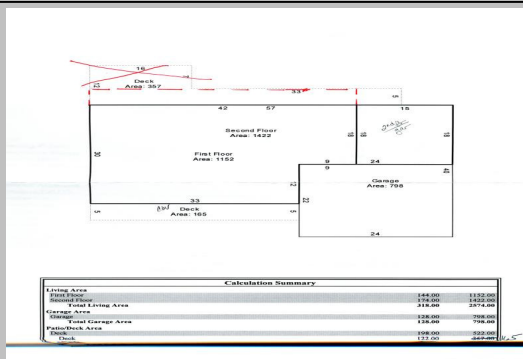

Sketch Updated: / /

BUILDING	Total Rooms	0	Year Built	2007	Building SF	2574	Energy Adj	No Data	Roughins	1
	Bedrooms	3	Effect Age	1.0	Quality	4.00	Bsmt Wall	NoData	Plumb Fixt	11
	Full Baths	2	Condition	Average	Style	2 Story	Bsmt SF	0.00	Fireplaces	0
	Half Baths	1	Phys Depr	0	Design	No Data	Bsmt Fin	No Data	Porch	375
	Kitchens	1	Funct Depr	0	Bldg Type	Single	Bsmt Fin SF	0	Gar/Shed	798
		Econ Depr	0					% Complete:	0	

INSPECT	INSP.	NoData	INSP.	NoData	INSP.	NoData	APPT	NoData	APPTSCHD
----------------	-------	--------	-------	--------	-------	--------	------	--------	----------

NOTES